

REVISIONS		
REV	DESCRIPTION	DATE

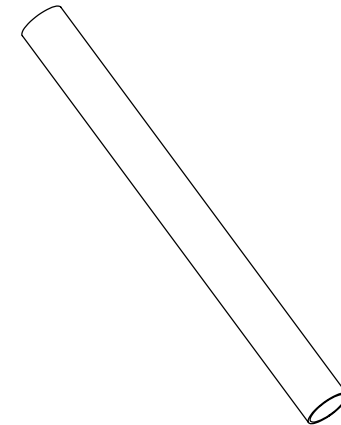
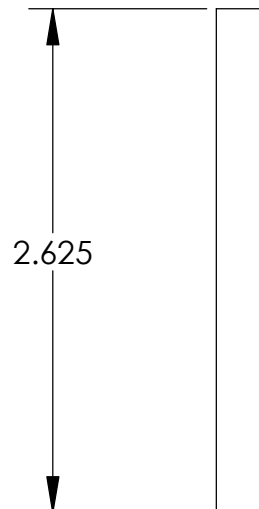
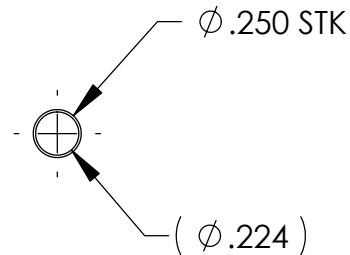

NOTES:  
1. MAKE FROM .250 X .013" WALL TUBING.

UNLESS OTHERWISE SPECIFIED:		<div>High Precision Devices</div> <div>1668 Valtec Lane, Suite C, Boulder, Colorado 80301 Phone: (303) 447-2558 Fax: (303) 447-2548 Web Site: www.hpd-online.com</div>				
DIMENSIONS ARE IN INCHES DECIMAL TOLERANCES: .X ±.030 .XX ±.015 .XXX ±.005						
ANGULAR TOL: ± 1° SURFACE ROUGHNESS:√63/		TITLE: <div>p02101-143 tube, support</div>				
INTERNAL AND EXTERNAL SURFACE INTERSECTIONS SHALL BE UNIFORMLY FINISHED WITH CHAMFER .005/.010 X 45° OR RADIUS .005/.010. CHAMFER ALL THREADED HOLES 110° OF MAJOR DIAMETER X 45°						
MATERIAL: 304/316 SST TUBE		CONFIGURATION: 0-Default				
FINISH: NONE	A	SIZE	QTY PER ASSM: 12	SCALE: 1:1	SHEET 1 OF 1	REV A
		DATE: 5/21/2004	DRAWN BY: C. Danaher			